

77

No. 1124  
ATA Code 27-15

**SUBJECT:** CONTROL COLUMN - INSTALLATION OF A FOOT GUARD

**EFFECTIVITY:** BEEHCRAFT Skipper 77, serials WA-2 through WA-80.

**REASON:** To reduce the possibility of the pilot's or copilot's foot being caught forward of the control column floor console.

**COMPLIANCE:** Beech Aircraft Corporation considers this to be a mandatory modification and it should be accomplished as soon as possible after receipt of these Service Instructions, but no later than the next scheduled inspection.

**APPROVAL:** FAA Approved - DOA CE-2.

**MANPOWER:** The following information is for planning purposes only:  
Estimated man-hours: 2 hours.  
Suggested number of men: 1 man.

**MATERIAL:** The following parts required for this modification may be ordered through BEEHCRAFT Aero or Aviation Centers and International Distributors and Dealers.

PART NUMBER	DESCRIPTION	QUANTITY PER AIRPLANE
108-420022-3	Brace	2
AN525-832R6	Screw	4
NAS1329A08K75	Rivnut	2
130290-3	Clipnut	2

**WARRANTY:** Warranty credit for parts and labor to the extent noted under MATERIAL and MANPOWER will be allowed on all affected airplanes for claims submitted prior to November 1, 1980.

All warranty reimbursements are handled through franchised BEEHCRAFT outlets. Owners and operators may arrange with these outlets to perform the work and submit the standard Beech Aircraft Corporation warranty claim form to the Commercial Service Department, Beech Aircraft Corporation, Wichita, Kansas 67201.

DJ-44  
580 II

1 of 3

Beech Aircraft Corporation issues service information for the benefit of owners and fixed base operators in the form of three classes of Service Instructions. CLASS I (Red Border) are changes, inspections, and modifications that could affect safety. The factory considers compliance mandatory. CLASS II (Green Border) covers changes, modifications, improvements or inspections the factory feels will benefit the owner and although highly recommended, they are not considered mandatory compliance, unless specified at the time of issuance. Class I and II are mailed to:

- (a) BEEHCRAFT Aero or Aviation Centers and International Distributors and Dealers.
- (b) Owners of record on the FAA Registration list and the

BEEHCRAFT International Owner Notification Service List  
(c) Those having a publications subscription

CLASS III (No Border) covers changes which are optional, maintenance aids, product improvement kits and miscellaneous service information. Compliance is at the owner or operator's prerogative. Copies of Class III are distributed per a and c above. Information on Owner Notification Service or Subscriptions can be obtained through any BEEHCRAFT Aero or Aviation Center, International Distributor and Dealer, or the Factory. As Service Instructions are issued, temporary notation in the index should be made until the index is revised. Warranty will be allowed only when specifically defined in the Service Instructions and in accordance with Beech Warranty Policy.



**Service Instructions No. 1124**

**SPECIAL TOOLS:** None.

**WEIGHT AND BALANCE:** None.

**REFERENCES:** Skipper 77 Maintenance Manual copies, P/N 108-590000-7 or subsequent, Chapter 27-15 and Chapter 25-10.

**PUBLICATIONS AFFECTED:** It is recommended that a note be made to "See Service Instruction No. 1124" in the following:

Skipper 77 Maintenance Manual copies, P/N 108-590000-7 or subsequent, Chapter 27-15 and Chapter 25-10;

Skipper 77 Parts Catalog copies, P/N 108-590000-9 or subsequent, Chapter 27-15.

**ACCOMPLISHMENT INSTRUCTIONS:**

These Service Instructions may be accomplished as follows:

1. Remove the cockpit seats as described in the Maintenance Manual.
2. Locate a P/N 108-420022-3 brace between one top forward corner of the control console and the flange on the firewall as shown in the illustration.

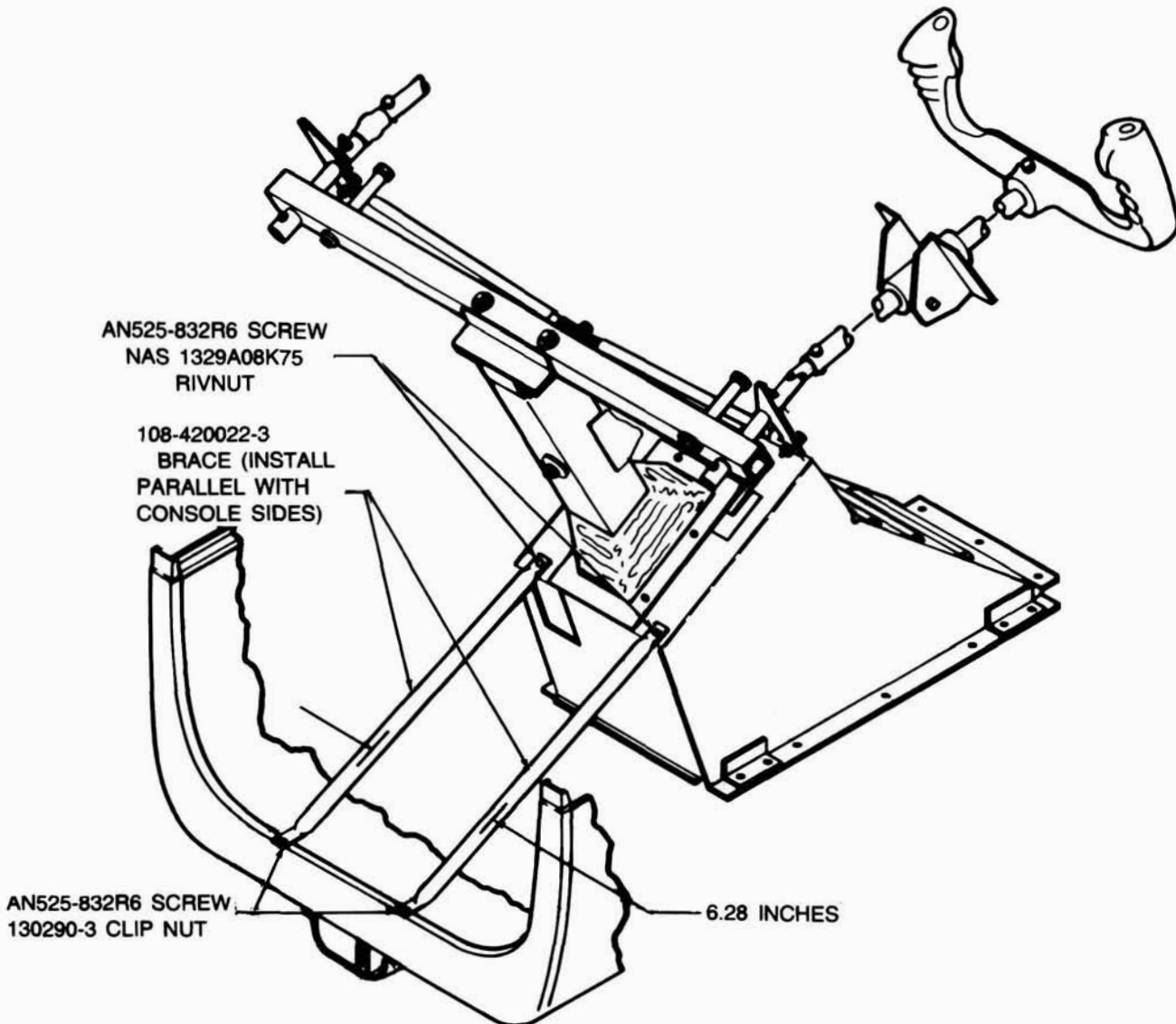

3. Using the holes in the brace as a guide, mark the positions of the holes to be drilled in the console and the flange.
4. In the console, drill a No. 2 (.221 inch diameter) hole at the location marked in step 3, notch the edge of the hole to fit the rivnut key, and install a P/N NAS1329A08K75 rivnut.
5. In the firewall flange, drill a No. 19 (.166 inch diameter) hole at the location marked in step 3 and install a P/N 130290-3 clipnut over the firewall flange with the nut on the lower side of the flange.
6. Locate the brace over the rivnut and clipnut and install the brace with P/N AN525-832R6 screws.
7. Repeat steps 1 through 6 on the opposite side of the console.
8. Replace the cockpit seats.

---

**RECORD COMPLIANCE:**

Upon completion of these Service Instructions, make an appropriate maintenance record entry.